

交流電壓 / 電流轉換器

DA/DV

- 特點：
- 精量單相二線, 三相三線交流電壓/電流
 - 扭曲的波形亦可準確的測量
 - 低輸出紋波
 - 低溫飄特性, 低衝擊電壓及隔離特性
 - 高穩定性 & 可靠度佳
 - 藉由類比輸出執行監控與控制
 - DIN-Rail軌道式安裝



■ 選用型號規格: D 輸入規格 - 接線方式 - 輸入範圍 - 輸入頻率 - 輸出範圍 - 工作電源

CODE	輸入規格
A	電流(平均值)
AT	電流(真實值)
V	電壓(平均值)
VT	電壓(真實值)

CODE	連接方式
12	單相二線
33	三相三線

CODE	輸入規格
A1	0-1A
A5	0-5A
V1	0-150V
V3	0-300V
V5	0-500V
AO	特殊規格
VO	特殊規格

CODE	輸入規格
5	50Hz ± 3Hz
6	60Hz ± 3Hz
O	特殊規格

CODE	輸出範圍	CODE	輸出範圍
A1	0-1mA	V1	0-1V
A2	0-5mA	V2	0-5V
A3	0-10mA	V3	0-10V
A4	0-20mA	V4	1-5V
A5	4-20mA	VO	特殊規格
AO	特殊規格		

· 無源是不可選用4-20mA, 1-5V和2-10V輸出方式

CODE	工作電源
A	AC 110/220 V
C	DC 24V
D	DC 48V
E	DC 110V
O	特殊規格

■ SPECIFICATION:

- ◆ Accuracy: ±0.2%RO.
- ◆ Aux.power supply: AC 150V/230V ± 15%, 50/60Hz
DC 24V, 48V, 110V ± 15%, 50/60Hz
- ◆ Power consumption: ≤ 2.5VA, ≤ DC 3W
- ◆ Power effect: ≤ 0.1% RO.
- ◆ Waveform effect: ≤ 0.2%RO.at distortion factor 30%
- ◆ Output load effect: ≤ 0.05%RO.
- ◆ Magnetic field strength: ≤ 0.2%RO., 400A/M
- ◆ Span adjustment range: ≥ 5%RO.
- ◆ Zero adjustment range: ≥ 1%RO.
- ◆ Operating temperature range: 0-60°C
- ◆ Storage temperature range: -10~70°C
- ◆ Temperature coefficient: ≤ 100PPM from 0 to 60°C
≤ 60PPM, 25°C ± 10°C
- ◆ Max.relative humidity: 95%
- ◆ Isolation: Input/output/power/case
- ◆ Insulation resistance: ≥ 100MΩ, DC500V
- ◆ Dielectric withstand voltage: Between Input/output/power/case
(IEC414, 688, ANSI, C37) AC 2.6KV, 60Hz, 1min.
- ◆ Impulse withstand test: 5KV, 1.2×50 μsec
(IEC 255-4, ANSI C37 90a) Common mode&differential mode
- ◆ Performance: Designed to comply with IEC688
- ◆ Safety requirements: IEC414, BS5458

● INPUT

Input Range	Input Burden	Input Frequency	Max. Input Over capability
0 ~ 1A	≤ 0.1VA	50Hz ± 3Hz	3 X rated continuous 10 X rated 10 sec. 50 X rated 1 sec.
0 ~ 5A		or 60Hz ± 3Hz	

● OUTPUT

DC Output Range	Load Resistance	Output Resistance	Output Ripple	Response Time
0 ~ 1V	≥ 1KΩ	≤ 0.05Ω	≤ 0.5% RO. (Peak)	≤ 400mS. 0 ~ 99%
0 ~ 5V				
1 ~ 5V				
0 ~ 10V				
0 ~ 1mA	0 ~ 10KΩ	≥ 20MΩ		
0 ~ 10mA	0 ~ 1KΩ	≥ 5MΩ		
0 ~ 20mA	0 ~ 500Ω			
4 ~ 20mA				

■ INPUT-OUTPUT CURVE :

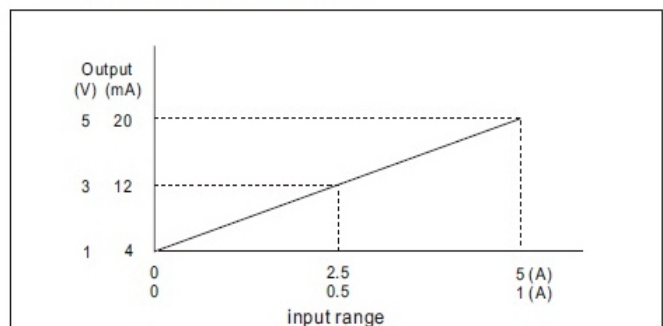

DESCRIPTION:

Model: DA/DV-1 1Φinput(AVG)
DA/DV-3 3Φinput(AVG)

Sinusoidal Waveforms-AVG.

DA/DV Series Transducer converting a sinusoidal alternating current into a dc output, proportional to the RMS value of input. These units are average sensing, but RMS calibrated for a sine wave with less than 1% distortion. The input signal is converted to a dc voltage which then feeds to a single stage amplifier and a dc output produced.

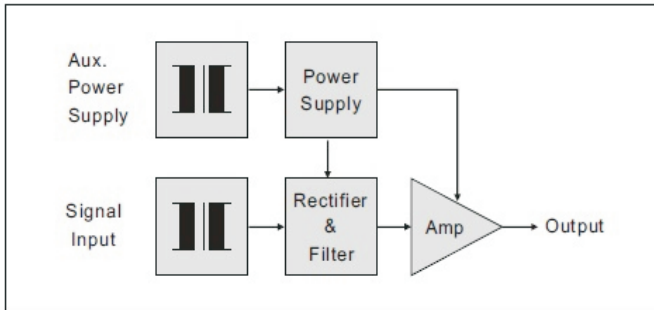

CONNECTION DIAGRAM:

• 單相二線(電源式)

電流輸入

電壓輸入

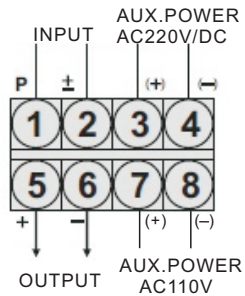
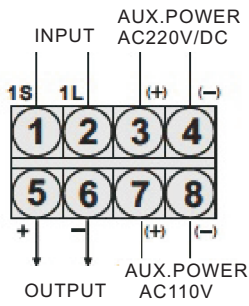

• 三相三線(電源式)

電流輸入

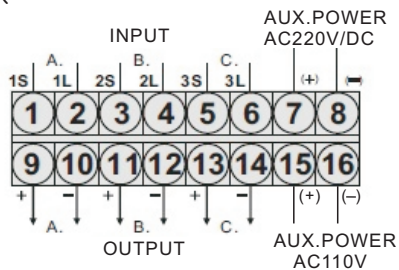

電壓輸入

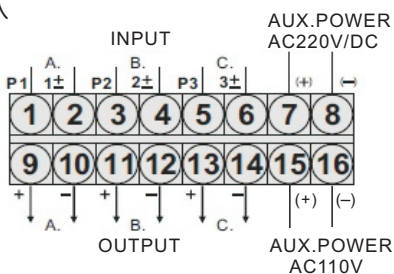

THE OUTSIDE DIMENSION (UNIT :mm)

• 單相

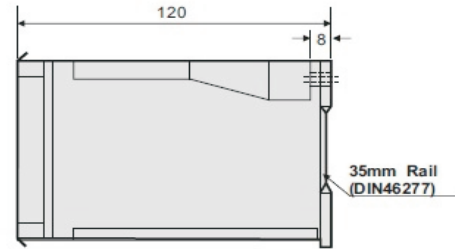
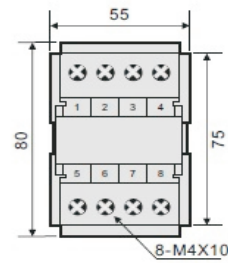

PANEL MOUNTING HOLE

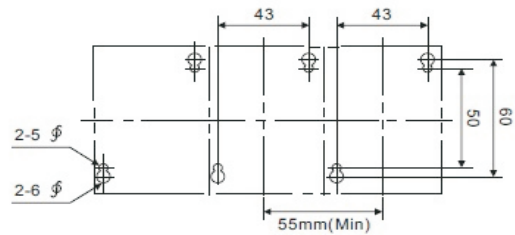

• 三相

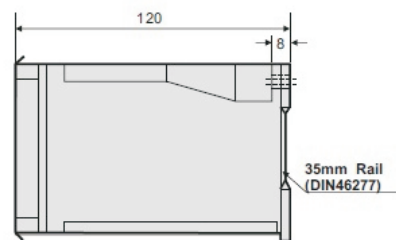
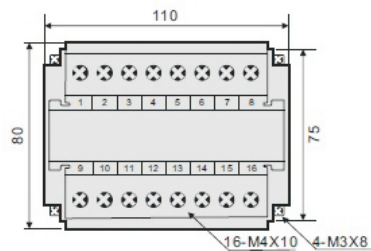

PANEL MOUNTING HOLE

