

尺寸及量程 / Size and Capacity

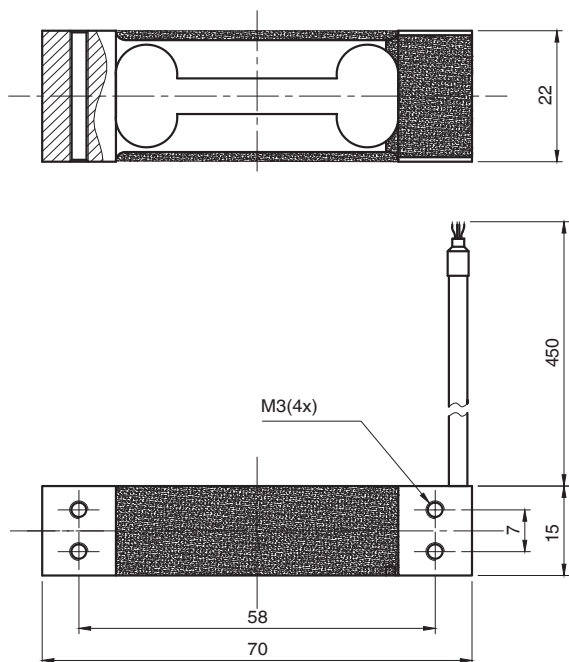

特点和用途 / Features & Applications

- 单点式平行梁结构传感器
- 铝合金材料，表面氧化
- 精度高，抗偏载能力强
- 结构非常紧凑，很轻，外形轮廓低，并且易于安装，IP65
- 适用于计价秤、计数秤、电子天平
- Single point load cell
- Made of aluminum alloy, surface anodized
- High accuracy, high side load tolerance
- Compact structure, very light, small size with profile, and easy to install, very stable, IP65
- Mainly used for pricing scales, counting scales, balance, etc

量程 / Capacity (kg)	材料 / Material	重量 / Weight
0.3/0.5/1/1.5/2/3/4/5/10	铝合金 / Aluminum alloy	0.1kg

技术参数 / Technical Parameters

参数	Specifications	技术指标 / Technique
输出灵敏度	Rated output	1.0±0.1 mV/V (0.3...0.5kg) 2.0±0.2 mV/V (1...10kg)
零点输出	Zero balance	±2% F.S.
非线性	Non-linearity	±0.02% F.S.
滞后	Hysteresis	±0.02% F.S.
重复性	Repeatability	±0.02% F.S.
蠕变 (30分钟)	Creep (30min)	±0.02% F.S.
灵敏度温度漂移	Temp. effect on output	0.025% F.S. / 10°C
零点温度漂移	Temp. effect on zero	0.025% F.S. / 10°C
输入电阻	Input impedance	410 ± 10 Ω
输出电阻	Output impedance	350 ± 5 Ω
绝缘电阻	Insulation	≥5000MΩ/100VDC
激励电压	Recommended excitation	5...10VDC
最大激励电压	Maximum excitation	15VDC
温度补偿范围	Compensated temp. range	-10 ... 40°C
工作温度范围	Operation temp. range	-20 ... 65°C
安全超载	Safe overload	150% F.S.
极限超载	Ultimate overload	200% F.S.
电缆线尺寸	Cable size	Ø3 × 450 mm
台面尺寸	Platform size	200 × 200 mm
防护等级	Protection class	IP65
连接方式	Cable color code	Input: Red(+) Black(-); Output: Green(+) White(-); 输入: 红 (+) 黑 (-); 输出: 绿 (+) 白 (-);

受力方式 / Load Direction

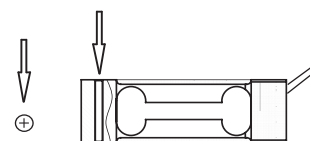

接线图 / Schematic Wiring Diagram

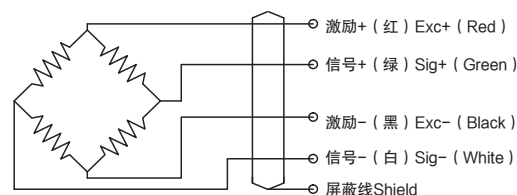

注：屏蔽线不与弹性体相连。
Cable shield is not connected to element.